

BASECAMP STARTER KIT

1. SORT YOUR TRASH



Please use the trash stations, clearly marked on the map - and make sure to put all your trash in the right bin. Help us care for environment.

2. REACH OUT FOR EMERGENCIES



Basecamp: _____ **+45 7210 9001**

Police: _____ **114**

Fire department, ambulance, etc: **112**

3. HEATING



The white knob on the radiator regulates heating. 1 = low, 5 = high. Try to keep it between 1-3. Remember to close it, when you have the windows open.



4. WI-FI

Basecamp wi-fi - password: **BaseCamp1771**
For private wi-fi, please contact Zibra (helpdesk@zibrawireless.dk) with your room number and you'll receive your personal wi-fi code.



5. COMMUNITY

Find us on Facebook:
Basecamp CPH - Residents only



6. SHARING IS CARING

Please think of your fellow Basecampers and donate useful items in good shape if you have anything that you no longer need. You can see where to donate on the map. You can also find lost items there. See map (SYMS). Open every Thursday 19:00 -19:30



7. WE ARE GRESB CERTIFIED

So, act green, reduce chemicals, and sort your waste.

- Enjoy All Basecamp has to offer.
- Be yourself and meet new people.
- Attend community events.
- Get to know your neighbors.
- Join our community and get involved.
- Clean up after yourself and sort your waste.
- Watch your noise levels.
- Ask the Basecamp team for assistance when you need it.
- Threat others with respect and kindness.

DO!

- Just stay in your room.
- Forget your key-but if you do, call +4572109001.
- Just throw things away - use the recycling.
- Damage your room or common areas.
- Burn anything - including candles, smokables, and even toast.
- Be a bad neighbor - keep the noise down after 23:00
- Paint, screw holes, drill or remove any furniture.
- Smoke inside.
- Leave things in hallways when moving out.
- Leave kitchenware in common kitchens.

DON'T!

BASEMANAGERS manages the daily operation of the Basecamp community. They are here to answer your questions and help in any way they can.

BASEBUDDIES are ambassadors, event planners, emergency support, and administration assistants. They are on-call during nights, weekends, and holidays as a part of the overall Basecamp property staff.

YOUR ARE NOW A PART OF BASECAMP FAMILY.

We have different events every month here at Basecamp: a great chance to get to know new people and participate in cool activities:) We are a big family of 500 people, you can all use the common areas, but please remember to clean after yourself; when you use the kitchen do not leave any utensils around.

Cleaning rules:

- Don't use metal or any sharp object on the stove.
- Remove limescale from both your bathroom and the kitchen sink.
- You can borrow the vacuum cleaner from the office (remember a picture ID), but bring it back right after use.
- Clean your drain. If you need to open it, you can borrow the tool from the office.
- Remember to clean the exhausts in the room: one in the bathroom, one in the room, one in the kitchen.
- Always clean up after yourself and leave the mess in your own room.

BASECAMP COPENHAGEN CITY

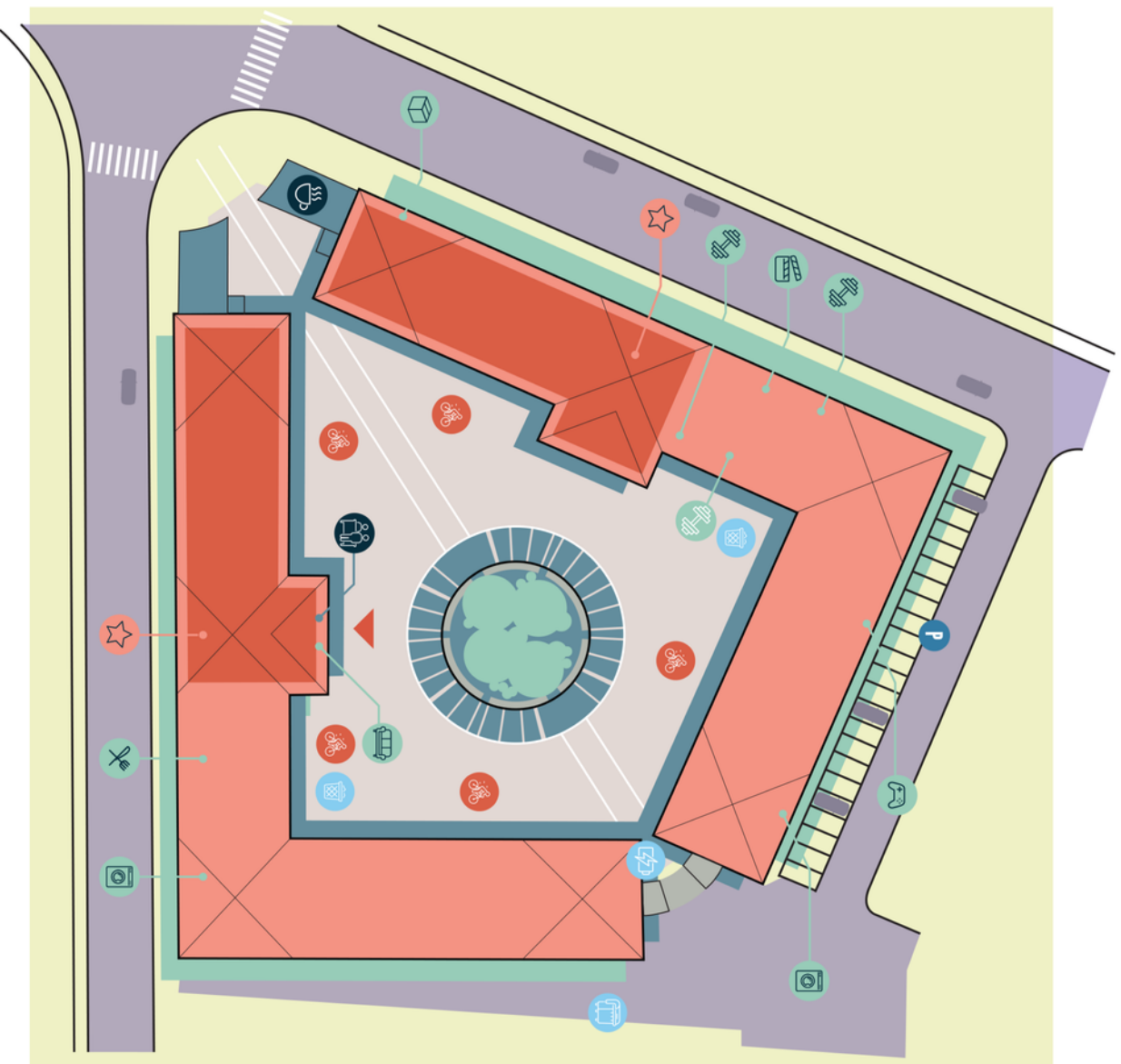

MAP LEGEND:

- Basement
- Ground floor outdoor lounge
- 5th floor

BASEMENT

- Laundry room
- Kitchen
- Plug & Play
- Cinema
- Gym
- Mailboxes
- Lounge room

GROUND FLOOR

- Reception — Monday 9am-12noon / 2pm-5pm
 - Tuesday 9am-12noon / 2pm-5pm
 - Wednesday 9am-12noon / 2pm-5pm
 - Thursday 9am-12noon / 2pm-7pm
 - Friday 8am-12noon / 2pm-4pm
 - Jack's Hole in a wall
- Closed on weekends and bank holidays.

5TH FLOOR

- The Roof: study, cook and chill

OUTSIDE

- Bike parking
- Bulk trash
- Batteries and electronic trash
- Trash